

GAUGE CHART

| Carbon Sheets to U.S. Standard or Manufacturers Gauge | | | Galvanized Sheets to Galvanized Sheet Gauge | |
|--|-----------|------------|--|------------|
| Gauge | Thickness | Lbs/Sq.Ft. | Thickness | Lbs/Sq.Ft. |
| 3 | .2391" | 10.00 | - | - |
| 4 | .2242 | 9.375 | - | - |
| 5 | .2092 | 8.750 | - | - |
| 6 | .1943 | 8.125 | - | - |
| 7 | .1793 | 7.500 | - | - |
| 8 | .1644 | 6.875 | .1681 | 7.031 |
| 9 | .1495 | 6.250 | .1532 | 6.406 |
| 10 | .1345 | 5.625 | .1382 | 5.781 |
| 11 | .1196 | 5.000 | .1233 | 5.516 |
| 12 | .1046 | 4.375 | .1084 | 4.531 |
| 13 | .0897 | 3.750 | .0934 | 3.906 |
| 14 | .0747 | 3.125 | .0785 | 3.281 |
| 15 | .0673 | 2.813 | .0710 | 2.969 |
| 16 | .0598 | 2.500 | .0635 | 2.656 |
| 17 | .0538 | 2.250 | .0575 | 2.406 |
| 18 | .0478 | 2.000 | .0516 | 2.156 |
| 19 | .0418 | 1.750 | .0456 | 1.906 |
| 20 | .0359 | 1.500 | .0396 | 1.656 |
| 21 | .0329 | 1.375 | .0366 | 1.531 |
| 22 | .0299 | 1.250 | .0336 | 1.406 |
| 23 | .0269 | 1.125 | .0306 | 1.281 |
| 24 | .0239 | 1.000 | .0276 | 1.156 |
| 25 | .0209 | .8750 | .0247 | 1.031 |
| 26 | .0179 | .7500 | .0217 | .9063 |
| 27 | .0164 | .6875 | .0202 | .8438 |
| 28 | .0149 | .6250 | .0187 | .7813 |
| 29 | .0135 | .5625 | .0172 | .7188 |
| 30 | .0120 | .5000 | .0157 | .6563 |

- 3/16" thickness and larger are classified as plates
- Sheets ordered by gauge weight or thickness are subject to standard thickness and weight tolerances
- The Galvanized Sheet Gauge is based on the U.S. Standard Gauge
- Each Galvanized Sheet Gauge Number is 2.5 ounces per sq. ft. heavier or .0037" thicker than the weight or thickness of the corresponding U.S. Standard Gauge Number, regardless of coating or weights.

BAR SELECTION GUIDE

HOT ROLLED RODS AND BARS

MERCHANT BAR QUALITY - These bars should be free from visible pipping. However, seams and other surface irregularities may be present. A general purpose mild steel which is easily fabricated by the usual methods. It is used in structural and non-critical applications involving mild cold bending, mild hot forming, punching and welding. Not recommended for forging, heat treating or intricate machining operations. ASTM A575 and QQ-S-630.

LOW CARBON - M1010 - Low carbon, general purpose merchant quality steel that features economy and formability and weldability. Hot Rolled Strip is often referred to as "band iron". Used for a variety of applications requiring a steel that can be cold formed, such as strapping, banding, ornamental iron work, brackets, etc.

M1020 - Low carbon, general purpose merchant quality steel. Produced to wider carbon and manganese ranges than standard steels. Suitable for forming and welding.

MEDIUM CARBON - M1044 - Similar to AISI 1045. Contains smaller amounts of manganese (.25/.60) therefore its strength and responsiveness to heat treatment are slightly lower.

ASTM A36 - These bars are designed for use in structural applications. 36,000 psi yield strength and 58,000 psi tensile strength.

COLD FINISHED RODS AND BARS

LOW CARBON - 1018 - This is a low carbon steel with a medium manganese content. Features good hardening properties, fair machinability and superior cold bending and forming use. Used for parts requiring cold forming, such as crimping, bending or swaging. Responds to any standard hardening methods including carburizing and heat treatments. Easily brazed and welded. Suitable for shafting and all applications that do not require the greater strength of high carbon and alloy steels. ASTM A-108.

GROUND & POLISHED SHAFTING (TG&P)

TURNED, GROUND AND POLISHED (TG&P) - Bars feature accurate size, straightness and concentricity to minimize wear in high speed applications. Because cold drawing strains are not developed these bars can be machined asymmetrically, such as for use in keyseating, with minimum distortion. TG&P bars combine the strength of cold drawn stock with additional accuracy and a lustrous finish. ASTM A-108 and QQ-S-637.

HOT ROLLED SQUARE

- Conforms to ASTM A36 and A709 GD36
- Lengths Available: 20 Ft.

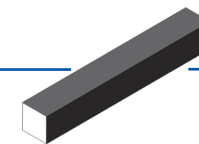

| Size | Part No. | Est. Weight - Lbs. | |
|--------|----------|--------------------|--------|
| | | Per Ft. | 20 Ft. |
| 3/8" | Y0472 | .478 | 9.56 |
| 1/2" | Y0474 | .850 | 17.00 |
| 5/8" | Y0475 | 1.33 | 26.56 |
| 3/4" | Y0476 | 1.91 | 38.26 |
| 7/8" | - | 2.60 | 52.06 |
| 1" | Y0478 | 3.40 | 68.00 |
| 1-1/8" | - | 4.30 | 86.06 |

| Size | Part No. | Est. Weight - Lbs. | |
|--------|----------|--------------------|--------|
| | | Per Ft. | 20 Ft. |
| 1-1/4" | Y0479 | 5.31 | 106.30 |
| 1-3/8" | - | 6.43 | 128.60 |
| 1-1/2" | Y0484 | 7.65 | 153.00 |
| 1-3/4" | - | 10.41 | 208.20 |
| 2" | Y0488 | 13.60 | 272.00 |
| 2-1/4" | - | 17.21 | 344.20 |
| 2-1/2" | - | 21.25 | 425.00 |

HOT ROLLED ROUNDS

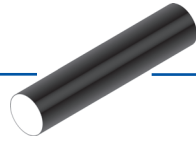

- Conforms to ASTM A36 and A709 GD36
- Lengths Available: 20 Ft.

| Size | Part No. | Est. Weight - Lbs. | |
|--------|----------|--------------------|--------|
| | | Per Ft. | 20 Ft. |
| 1/4" | Y0400 | .167 | 3.34 |
| 5/16" | - | .261 | 5.22 |
| 3/8" | Y0402 | .376 | 7.52 |
| 7/16" | - | .511 | 10.22 |
| 1/2" | Y0404 | .668 | 13.36 |
| 9/16" | Y0405 | .845 | 16.90 |
| 5/8" | Y0406 | 1.04 | 20.86 |
| .680 | - | 1.26 | 25.20 |
| 3/4" | Y0410 | 1.50 | 30.04 |
| 25/32" | - | 1.63 | 32.60 |
| 7/8" | Y0414 | 2.04 | 40.88 |
| 29/32" | - | 2.19 | 43.80 |
| 1" | Y0416 | 2.67 | 53.40 |
| 1-1/8" | - | 3.38 | 67.58 |
| 1.145" | - | 3.47 | 69.40 |
| 1-1/4" | Y0419 | 4.17 | 83.46 |
| 1-3/8" | Y8432 | 5.05 | 101.00 |

| Size | Part No. | Est. Weight - Lbs. | |
|--------|----------|--------------------|---------|
| | | Per Ft. | 20 Ft. |
| 1-1/2" | Y0422 | 6.01 | 120.20 |
| 1-5/8" | - | 7.05 | 141.00 |
| 1-3/4" | Y0424 | 8.18 | 163.60 |
| 1-7/8" | - | 9.39 | 187.80 |
| 2" | Y0425 | 10.68 | 213.60 |
| 2-1/8" | - | 12.06 | 241.20 |
| 2-1/4" | - | 13.52 | 270.40 |
| 2-3/8" | - | 15.06 | 301.20 |
| 2-1/2" | - | 16.69 | 333.80 |
| 2-5/8" | - | 18.40 | 368.00 |
| 2-3/4" | - | 20.20 | 404.00 |
| 2-7/8" | - | 22.07 | 441.40 |
| 3" | - | 24.03 | 480.60 |
| 3-1/2" | - | 32.71 | 654.20 |
| 4" | - | 42.73 | 854.60 |
| 5" | - | 66.76 | 1335.20 |
| 6" | - | 96.13 | 1922.60 |

REINFORCING BARS (REBAR)

Deformed steel reinforcement bars are for use as reinforcement in concrete construction. Small lugs are provided on the surface of the bar which inhibits longitudinal movement of the bar relative to the concrete which surrounds it.

- A615 / Grade 60
- Lengths Available: 20 Ft.

| mm | Bar Size | | Part No. | Weight Per Ft. | Nominal Dimensions | | |
|----|----------|-----|----------|----------------|--------------------|------|-----------|
| | Inches | No. | | | Dia. | Area | Perimeter |
| 10 | 3/8" | 3 | Y0446 | .376 | .375 | .11 | 1.178 |
| 13 | 1/2" | 4 | Y0444 | .668 | .500 | .20 | 1.571 |
| 16 | 5/8" | 5 | Y0442 | 1.043 | .625 | .31 | 1.963 |
| 19 | 3/4" | 6 | Y0440 | 1.502 | .750 | .44 | 2.356 |
| 22 | 7/8" | 7 | - | 2.044 | .875 | .60 | 2.749 |
| 25 | 1" | 8 | - | 2.670 | 1.000 | .79 | 3.142 |
| 29 | 1" | 9 | - | 3.400 | 1.128 | 1.00 | 3.544 |
| 32 | 1-1/8" | 10 | - | 4.303 | 1.270 | 1.27 | 3.990 |
| 36 | 1-1/4" | 11 | - | 5.313 | 1.410 | 1.56 | 4.430 |

HOT ROLLED STRIP BAR

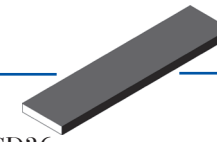

Bars

- Conforms to ASTM A36 and A709 GD36
- Lengths Available: 20 Ft.

| Size | Part No. | Est. Weight - Lbs. | |
|----------------|----------|--------------------|--------|
| | | Per Ft. | 20 Ft. |
| 1/8 x 1/2" | Y0200 | .213 | 426 |
| 1/8" x 5/8" | - | .266 | 5.32 |
| 1/8" x 3/4" | Y0202 | .319 | 6.38 |
| 1/8" x 1" | Y0203 | .425 | 8.50 |
| 1/8" x 1-1/8" | - | .478 | 9.56 |
| 1/8" x 1-1/4" | Y0204 | .531 | 10.62 |
| 1/8" x 1-1/2" | Y0205 | .638 | 12.76 |
| 1/8" x 1-3/4" | - | .744 | 14.88 |
| 1/8" x 2" | Y0206 | .850 | 17.00 |
| 1/8" x 2-1/2" | Y0207 | 1.06 | 21.26 |
| 1/8" x 3" | Y0208 | 1.28 | 25.50 |
| 1/8" x 4" | Y0210 | 1.70 | 34.00 |
| 1/8" x 5" | Y0211 | 2.13 | 42.50 |
| 1/8" x 6" | Y0212 | 2.55 | 51.00 |
| 1/8" x 7" | - | 2.98 | 59.60 |
| 1/8" x 8" | - | 3.41 | 68.20 |
| 1/8" x 10" | - | 4.25 | 85.00 |
| 1/8" x 12" | - | 5.10 | |
| 3/16" x 1/2" | - | .319 | 6.38 |
| 3/16" x 5/8" | - | .398 | 7.96 |
| 3/16" x 3/4" | - | .478 | 9.56 |
| 3/16" x 1" | Y0216 | .638 | 12.76 |
| 3/16" x 1-1/8" | - | .717 | 14.34 |
| 3/16" x 1-1/4" | Y0218 | .797 | 15.94 |
| 3/16" x 1-1/2" | Y0219 | .956 | 19.12 |
| 3/16" x 1-3/4" | - | 1.12 | 22.32 |
| 3/16" x 2" | Y0220 | 1.28 | 25.50 |
| 3/16" x 2-1/2" | Y0221 | 1.59 | 31.88 |

| Size | Part No. | Est. Weight - Lbs. | |
|----------------|----------|--------------------|--------|
| | | Per Ft. | 20 Ft. |
| 3/16" x 2-3/4" | - | 1.75 | 35.06 |
| 3/16" x 3" | Y0222 | 1.91 | 38.26 |
| 3/16" x 4" | Y0224 | 2.55 | 51.00 |
| 3/16" x 5" | Y0226 | 3.19 | 63.76 |
| 3/16" x 6" | Y0228 | 3.83 | 76.50 |
| 3/16" x 7" | - | 4.46 | 89.20 |
| 3/16" x 8" | Y8229 | 5.11 | 102.20 |
| 3/16" x 10" | - | 6.38 | 127.50 |
| 3/16" x 12" | - | 7.66 | 153.00 |
| 1/4" x 1/2" | - | .425 | 8.50 |
| 1/4" x 5/8" | - | .531 | 10.62 |
| 1/4" x 3/4" | - | .638 | 12.76 |
| 1/4" x 1" | - | .850 | 14.45 |
| 1/4" x 1-1/8" | - | .956 | 19.12 |
| 1/4" x 1-1/4" | - | 1.06 | 21.20 |
| 1/4" x 1-1/2" | - | 1.28 | 25.60 |
| 1/4" x 1-3/4" | - | 1.49 | 29.80 |
| 1/4" x 2" | - | 1.70 | 34.00 |
| 1/4" x 2-1/2" | - | 2.13 | 42.60 |
| 1/4" x 2-3/4" | - | 2.34 | 46.80 |
| 1/4" x 3" | - | 2.55 | 51.00 |
| 1/4" x 4" | - | 3.40 | 68.00 |
| 1/4" x 5" | - | 4.25 | 85.00 |
| 1/4" x 6" | - | 5.10 | 102.00 |
| 1/4" x 7" | - | 5.95 | 119.00 |
| 1/4" x 8" | - | 6.80 | 136.00 |
| 1/4" x 10" | - | 8.51 | 170.20 |
| 1/4" x 12" | - | 10.21 | 204.20 |

HOT ROLLED FLAT BAR

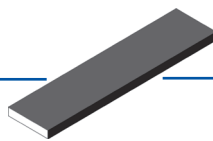

- Conforms to ASTM A36 and A709 GD36
- Lengths Available: 20 Ft.

| Size | Est. Weight - Lbs. | | Part No. |
|----------------|--------------------|--------|----------|
| | Per Ft. | 20 Ft. | |
| 1/4" x 1/2" | .425 | 8.50 | Y0229 |
| 1/4" x 5/8" | .531 | 10.62 | - |
| 1/4" x 3/4" | .638 | 12.76 | Y0230 |
| 1/4" x 7/8" | .744 | 14.88 | - |
| 1/4" x 1" | .850 | 17.00 | Y0232 |
| 1/4" x 1-1/8" | .956 | 19.12 | - |
| 1/4" x 1-1/4" | 1.063 | 21.26 | Y0233 |
| 1/4" x 1-3/8" | 1.169 | 23.38 | - |
| 1/4" x 1-1/2" | 1.275 | 25.50 | Y0234 |
| 1/4" x 1-5/8" | 1.381 | 27.62 | - |
| 1/4" x 1-3/4" | 1.488 | 29.76 | - |
| 1/4" x 2" | 1.700 | 34.00 | Y0236 |
| 1/4" x 2-1/4" | 1.913 | 38.26 | Y0235 |
| 1/4" x 2-1/2" | 2.125 | 42.50 | Y0237 |
| 1/4" x 2-3/4" | 2.338 | 46.76 | - |
| 1/4" x 3" | 2.550 | 51.00 | Y0238 |
| 1/4" x 3-1/4" | 2.763 | 55.26 | - |
| 1/4" x 3-1/2" | 2.975 | 59.50 | Y0239 |
| 1/4" x 3-3/4" | 3.188 | 63.76 | - |
| 1/4" x 4" | 3.400 | 68.00 | Y0240 |
| 1/4" x 4-1/2" | 3.825 | 76.50 | - |
| 1/4" x 5" | 4.250 | 85.00 | Y0242 |
| 1/4" x 5-1/2" | 4.675 | 93.50 | - |
| 1/4" x 6" | 5.100 | 102.00 | Y0243 |
| 1/4" x 7" | 5.950 | 119.00 | - |
| 1/4" x 8" | 6.800 | 136.00 | Y0350 |
| 5/16" x 1/2" | .531 | 10.62 | - |
| 5/16" x 5/8" | .664 | 13.28 | - |
| 5/16" x 3/4" | .797 | 15.84 | - |
| 5/16" x 7/8" | .930 | 18.60 | - |
| 5/16" x 1" | 1.063 | 21.26 | - |
| 5/16" x 1-1/8" | 1.195 | 23.90 | - |
| 5/16" x 1-1/4" | 1.328 | 26.56 | - |
| 5/16" x 1-3/8" | 1.461 | 29.22 | - |
| 5/16" x 1-1/2" | 1.594 | 31.88 | - |
| 5/16" x 1-3/4" | 1.859 | 37.18 | - |
| 5/16" x 2" | 2.125 | 42.50 | - |
| 5/16" x 2-1/4" | 2.391 | 47.82 | - |

| Size | Est. Weight - Lbs. | | Part No. |
|----------------|--------------------|--------|----------|
| | Per Ft. | 20 Ft. | |
| 5/16" x 2-1/2" | 2.656 | 53.12 | - |
| 5/16" x 2-3/4" | 2.922 | 58.44 | - |
| 5/16" x 3" | 3.188 | 63.76 | - |
| 5/16" x 3-1/2" | 3.719 | 74.38 | - |
| 5/16" x 4" | 4.250 | 85.00 | - |
| 5/16" x 4-1/2" | 4.781 | 95.62 | - |
| 5/16" x 5" | 5.313 | 106.26 | - |
| 5/16" x 5-1/2" | 5.844 | 116.68 | - |
| 5/16" x 6" | 6.375 | 127.50 | - |
| 5/16" x 7" | 7.438 | 148.75 | - |
| 5/16" x 8" | 8.500 | 170.00 | - |
| 5/16" x 9" | 9.570 | 191.40 | - |
| 5/16" x 10" | 10.630 | 212.60 | - |
| 5/16" x 11" | 11.700 | 234.00 | - |
| 5/16" x 12" | 12.760 | 255.20 | - |
| 3/8" x 1/2" | .638 | 12.76 | - |
| 3/8" x 5/8" | .797 | 15.94 | - |
| 3/8" x 3/4" | .956 | 19.12 | - |
| 3/8" x 7/8" | 1.116 | 22.32 | - |
| 3/8" x 1" | 1.276 | 25.52 | Y0252 |
| 3/8" x 1-1/8" | 1.434 | 28.68 | - |
| 3/8" x 1-1/4" | 1.594 | 31.88 | Y0253 |
| 3/8" x 1-3/8" | 1.753 | 35.06 | - |
| 3/8" x 1-1/2" | 1.913 | 38.26 | Y0254 |
| 3/8" x 1-5/8" | 2.072 | 41.44 | - |
| 3/8" x 1-3/4" | 2.231 | 44.62 | - |
| 3/8" x 2" | 2.550 | 51.00 | Y0255 |
| 3/8" x 2-1/4" | 2.869 | 57.38 | - |
| 3/8" x 2-1/2" | 3.188 | 63.76 | Y0257 |
| 3/8" x 2-3/4" | 3.506 | 70.12 | - |
| 3/8" x 3" | 3.825 | 76.50 | Y0258 |
| 3/8" x 3-1/4" | 4.144 | 82.88 | - |
| 3/8" x 3-1/2" | 4.463 | 89.26 | - |
| 3/8" x 4" | 5.100 | 102.00 | Y0260 |
| 3/8" x 4-1/2" | 5.738 | 114.76 | - |
| 3/8" x 5" | 6.375 | 127.50 | Y0261 |
| 3/8" x 5-1/2" | 7.013 | 140.26 | - |
| 3/8" x 6" | 7.650 | 153.00 | Y0262 |

| Size | Est. Weight - Lbs. | | Part No. |
|---------------|--------------------|--------|----------|
| | Per Ft. | 20 Ft. | |
| 3/8" x 7" | 8.925 | 178.50 | Y8465 |
| 3/8" x 8" | 10.200 | 204.00 | Y0353 |
| 1/2" x 5/8" | 1.063 | 21.26 | Y8417 |
| 1/2" x 3/4" | 1.275 | 25.50 | Y0263 |
| 1/2" x 7/8" | 1.488 | 29.76 | - |
| 1/2" x 1" | 1.700 | 34.00 | Y0264 |
| 1/2" x 1-1/8" | 1.913 | 38.26 | - |
| 1/2" x 1-1/4" | 2.125 | 42.50 | Y8437 |
| 1/2" x 1-3/8" | 2.338 | 46.76 | - |
| 1/2" x 1-1/2" | 2.550 | 51.00 | Y0265 |
| 1/2" x 1-3/4" | 2.975 | 59.50 | - |
| 1/2" x 2" | 3.400 | 68.00 | Y0266 |
| 1/2" x 2-1/4" | 3.825 | 76.50 | - |
| 1/2" x 2-1/2" | 4.250 | 85.00 | Y0267 |
| 1/2" x 2-3/4" | 4.675 | 93.50 | - |
| 1/2" x 3" | 5.100 | 102.00 | Y0268 |
| 1/2" x 3-1/4" | 5.525 | 110.50 | - |
| 1/2" x 3-1/2" | 5.950 | 119.00 | Y8433 |
| 1/2" x 4" | 6.800 | 136.00 | Y0270 |
| 1/2" x 4-1/2" | 7.650 | 153.00 | - |
| 1/2" x 5" | 8.500 | 170.00 | Y0272 |
| 1/2" x 5-1/2" | 9.350 | 187.00 | - |
| 1/2" x 6" | 10.200 | 204.00 | Y0273 |
| 1/2" x 7" | 11.900 | 238.00 | - |
| 1/2" x 8" | 13.600 | 272.00 | Y0356 |
| 5/8" x 3/4" | 1.594 | 31.88 | - |
| 5/8" x 7/8" | 1.859 | 37.18 | - |
| 5/8" x 1" | 2.125 | 42.50 | - |
| 5/8" x 1-1/8" | 2.391 | 47.82 | - |
| 5/8" x 1-1/4" | 2.656 | 53.12 | - |
| 5/8" x 1-1/2" | 3.188 | 63.76 | - |
| 5/8" x 1-3/4" | 3.719 | 74.38 | - |
| 5/8" x 2" | 4.250 | 85.00 | Y0275 |
| 5/8" x 2-1/4" | 4.781 | 95.62 | - |
| 5/8" x 2-1/2" | 5.313 | 106.26 | - |
| 5/8" x 2-3/4" | 5.844 | 116.88 | - |
| 5/8" x 3" | 6.375 | 127.50 | Y0276 |
| 5/8" x 3-1/4" | 6.906 | 138.12 | - |
| 5/8" x 3-1/2" | 7.438 | 148.76 | - |
| 5/8" x 4" | 8.500 | 170.00 | Y0278 |

| Size | Est. Weight - Lbs. | | Part No. |
|---------------|--------------------|--------|----------|
| | Per Ft. | 20 Ft. | |
| 5/8" x 4-1/2" | 9.563 | 191.26 | - |
| 5/8" x 5" | 10.625 | 212.50 | Y0279 |
| 5/8" x 5-1/2" | 11.688 | 233.76 | - |
| 5/8" x 6" | 12.750 | 255.00 | - |
| 5/8" x 7" | 14.875 | 297.50 | - |
| 5/8" x 8" | 17.000 | 340.00 | - |
| 3/4" x 7/8" | 2.231 | 44.62 | - |
| 3/4" x 1" | 2.550 | 51.00 | - |
| 3/4" x 1-1/8" | 2.869 | 57.38 | - |
| 3/4" x 1-1/4" | 3.188 | 63.76 | - |
| 3/4" x 1-1/2" | 3.825 | 76.50 | Y0281 |
| 3/4" x 1-3/4" | 4.463 | 89.26 | - |
| 3/4" x 2" | 5.100 | 102.00 | Y0282 |
| 3/4" x 2-1/4" | 5.738 | 114.76 | - |
| 3/4" x 2-1/2" | 6.375 | 127.50 | Y8439 |
| 3/4" x 2-3/4" | 7.013 | 140.26 | - |
| 3/4" x 3" | 7.650 | 153.00 | Y0284 |
| 3/4" x 3-1/4" | 8.288 | 165.76 | - |
| 3/4" x 3-1/2" | 8.925 | 178.50 | - |
| 3/4" x 4" | 10.200 | 204.00 | Y0287 |
| 3/4" x 4-1/2" | 11.475 | 229.50 | - |
| 3/4" x 5" | 12.750 | 255.00 | Y0289 |
| 3/4" x 5-1/2" | 14.025 | 280.50 | - |
| 3/4" x 6" | 15.300 | 306.00 | Y0290 |
| 3/4" x 7" | 17.850 | 357.00 | - |
| 3/4" x 8" | 20.400 | 408.00 | Y0291 |
| 7/8" x 1" | 2.975 | 59.50 | - |
| 7/8" x 1-1/4" | 3.719 | 74.38 | - |
| 7/8" x 1-1/2" | 4.463 | 89.26 | - |
| 7/8" x 1-3/4" | 5.206 | 104.12 | - |
| 7/8" x 2" | 5.950 | 119.00 | - |
| 7/8" x 2-1/4" | 6.694 | 133.88 | - |
| 7/8" x 2-1/2" | 7.438 | 148.76 | - |
| 7/8" x 2-3/4" | 8.181 | 163.62 | - |
| 7/8" x 3" | 8.925 | 178.50 | - |
| 7/8" x 3-1/2" | 10.413 | 208.26 | - |
| 7/8" x 4" | 11.900 | 238.00 | - |
| 7/8" x 4-1/2" | 13.388 | 267.76 | - |
| 7/8" x 5" | 14.875 | 297.50 | - |
| 7/8" x 6" | 17.850 | 357.00 | - |

HOT ROLLED FLAT BAR

| Size | Est. Weight - Lbs. | | Part No. |
|-----------------|--------------------|--------|----------|
| | Per Ft. | 20 Ft. | |
| 7/8" x 7" | 20.825 | 416.50 | - |
| 7/8" x 8" | 23.800 | 476.00 | - |
| 1" x 1-1/4" | 4.250 | 85.00 | - |
| 1" x 1-1/2" | 5.100 | 102.00 | - |
| 1" x 1-3/4" | 5.950 | 119.00 | - |
| 1" x 2" | 6.800 | 136.00 | Y0292 |
| 1" x 2-1/4" | 7.650 | 153.00 | - |
| 1" x 2-1/2" | 8.500 | 170.00 | Y0293 |
| 1" x 2-3/4" | 9.350 | 187.00 | - |
| 1" x 3" | 10.200 | 204.00 | Y0294 |
| 1" x 3-1/4" | 11.050 | 221.00 | - |
| 1" x 3-1/2" | 11.900 | 238.00 | - |
| 1" x 4" | 13.600 | 272.00 | Y0296 |
| 1" x 4-1/2" | 15.300 | 306.00 | - |
| 1" x 5" | 17.000 | 340.00 | Y0297 |
| 1" x 5-1/2" | 18.700 | 374.00 | - |
| 1" x 6" | 20.400 | 408.00 | Y0298 |
| 1" x 7" | 23.800 | 476.00 | - |
| 1" x 8" | 27.23 | 544.60 | Y0285 |
| 1-1/8" x 2" | 7.650 | 153.00 | - |
| 1-1/8" x 3" | 11.475 | 229.50 | - |
| 1-1/8" x 4" | 15.300 | 306.00 | - |
| 1-1/8" x 5" | 19.125 | 382.50 | - |
| 1-1/8" x 6" | 22.950 | 459.00 | - |
| 1-1/8" x 7" | 26.775 | 535.50 | - |
| 1-1/8" x 8" | 30.600 | 612.00 | - |
| 1-1/4" x 1-1/2" | 6.375 | 127.50 | - |
| 1-1/4" x 1-3/4" | 7.438 | 148.76 | - |
| 1-1/4" x 2" | 8.500 | 170.00 | Y8416 |
| 1-1/4" x 2-1/4" | 9.563 | 191.26 | - |
| 1-1/4" x 2-1/2" | 10.625 | 212.50 | - |
| 1-1/4" x 2-3/4" | 11.688 | 233.76 | - |
| 1-1/4" x 3" | 12.750 | 255.00 | Y0303 |
| 1-1/4" x 3-1/2" | 14.875 | 297.50 | - |
| 1-1/4" x 4" | 17.000 | 340.00 | Y0306 |
| 1-1/4" x 4-1/2" | 19.125 | 382.50 | - |
| 1-1/4" x 5" | 21.250 | 425.00 | - |
| 1-1/4" x 5-1/2" | 23.375 | 467.50 | - |
| 1-1/4" x 6" | 25.500 | 510.00 | Y0312 |
| 1-1/4" x 7" | 29.750 | 595.00 | - |

| Size | Est. Weight - Lbs. | | Part No. |
|-----------------|--------------------|---------|----------|
| | Per Ft. | 20 Ft. | |
| 1-1/4" x 8" | 34.000 | 680.00 | - |
| 1-1/2" x 2" | 10.200 | 204.00 | - |
| 1-1/2" x 2-1/2" | 12.750 | 255.00 | - |
| 1-1/2" x 3" | 15.300 | 306.00 | Y8435 |
| 1-1/2" x 3-1/2" | 17.850 | 357.00 | - |
| 1-1/2" x 4" | 20.400 | 408.00 | Y8461 |
| 1-1/2" x 4-1/2" | 22.950 | 459.00 | - |
| 1-1/2" x 5" | 25.500 | 510.00 | - |
| 1-1/2" x 6" | 30.600 | 612.00 | Y0327 |
| 1-1/2" x 7" | 35.700 | 714.00 | - |
| 1-1/2" x 8" | 40.800 | 816.00 | - |
| 1-3/4" x 2" | 11.900 | 238.00 | - |
| 1-3/4" x 2-1/2" | 14.875 | 297.50 | - |
| 1-3/4" x 3" | 17.850 | 357.00 | - |
| 1-3/4" x 3-1/2" | 20.825 | 416.50 | - |
| 1-3/4" x 4" | 23.800 | 476.00 | - |
| 1-3/4" x 4-1/2" | 26.775 | 535.50 | - |
| 1-3/4" x 5" | 29.750 | 595.00 | - |
| 1-3/4" x 6" | 35.700 | 714.00 | - |
| 1-3/4" x 7" | 41.650 | 833.00 | - |
| 1-3/4" x 8" | 47.600 | 952.00 | - |
| 2" x 2-1/2" | 17.00 | 340.00 | - |
| 2" x 3" | 20.400 | 408.00 | Y8434 |
| 2" x 3-1/2" | 23.800 | 476.00 | - |
| 2" x 4" | 27.200 | 544.00 | - |
| 2" x 4-1/2" | 30.600 | 612.00 | - |
| 2" x 5" | 34.000 | 680.00 | - |
| 2" x 6" | 40.800 | 816.00 | - |
| 2" x 7" | 47.600 | 952.00 | - |
| 2" x 8" | 54.400 | 1088.00 | - |
| 2-1/2" x 3" | 25.500 | 510.00 | - |
| 2-1/2" x 3-1/2" | 29.750 | 595.00 | - |
| 2-1/2" x 4" | 34.000 | 680.00 | - |
| 2-1/2" x 4-1/2" | 38.250 | 765.00 | - |
| 2-1/2" x 5" | 42.500 | 850.00 | - |
| 2-1/2" x 6" | 51.000 | 1020.00 | - |
| 2-1/2" x 7" | 59.500 | 1190.00 | - |
| 2-1/2" x 8" | 68.000 | 1360.00 | - |
| 3" x 4" | 40.800 | 816.00 | - |
| 3" x 4-1/2" | 45.900 | 918.00 | - |

COLD FINISHED ROUND BAR

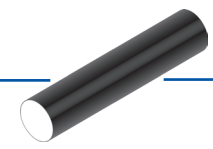

• C1018

| Size | Est. Weight - Lbs. | | Part No. |
|---------------|--------------------|--------|----------|
| | Per Ft. | 20 Ft. | |
| 1/8" x 12' | .042 | .84 | Y1499 |
| 3/16" x 12' | .094 | 1.88 | Y1500 |
| 1/4" x 12' | .167 | 3.34 | Y1502 |
| 1/4" x 20' | .167 | 3.34 | Y1501 |
| 5/16" x 12' | .261 | 5.22 | Y1498 |
| 3/8" x 20' | .376 | 7.52 | Y1504 |
| 7/16" x 20' | .511 | 10.22 | Y1505 |
| 1/2" x 20' | .668 | 13.36 | Y1506 |
| 9/16" x 20' | .845 | 16.90 | Y1507 |
| 5/8" x 20' | 1.043 | 20.86 | Y1508 |
| 11/16" x 12' | 1.262 | 25.24 | Y1497 |
| 3/4" x 20' | 1.500 | 30.00 | Y1510 |
| 13/16" x 20' | 1.763 | 35.26 | Y1511 |
| 7/8" x 20' | 2.044 | 40.88 | Y1512 |
| 15/16" x 20' | 2.347 | 46.94 | Y1513 |
| 1" x 12' | 2.670 | 53.40 | Y1494 |
| 1" x 20' | 2.670 | 53.40 | Y1514 |
| 1-1/16" x 12' | 3.015 | 60.30 | Y1495 |
| 1-1/16" x 20' | 3.015 | 60.30 | Y1515 |
| 1-1/8" x 20' | 3.380 | 67.60 | Y1516 |
| 1-3/16" x 20' | 3.766 | 75.32 | Y1517 |
| 1-1/4" x 20' | 4.172 | 83.44 | Y1518 |
| 1-5/16" x 20' | 4.600 | 92.00 | Y1519 |
| 1-3/8" x 20' | 5.049 | 100.98 | Y1520 |
| 1-7/16" x 20' | 5.53 | 110.60 | Y1521 |
| 1-1/2" x 20' | 6.008 | 120.16 | Y1522 |
| 1-9/16" | 6.519 | 130.38 | - |
| 1-5/8" x 20' | 7.051 | 141.02 | Y1524 |

| Size | Est. Weight - Lbs. | | Part No. |
|----------------|--------------------|---------|----------|
| | Per Ft. | 20 Ft. | |
| 1-11/16" x 20' | 7.604 | 152.08 | Y1525 |
| 1-3/4" x 20' | 8.178 | 163.56 | Y1526 |
| 1-13/16" | 8.773 | 175.46 | - |
| 1-7/8" x 20' | 9.388 | 187.76 | Y1528 |
| 1-15/16" x 20' | 10.024 | 200.48 | Y1529 |
| 2" | 10.681 | 213.62 | Y1530 |
| 2-1/8" | 12.058 | 241.16 | Y1532 |
| 2-3/16" | 12.778 | 255.56 | Y1533 |
| 2-1/4" | 13.519 | 270.38 | Y1534 |
| 2-5/16" | 14.280 | 285.60 | Y1535 |
| 2-3/8" | 15.08 | 301.60 | Y1536 |
| 2-7/16" | 15.870 | 317.40 | Y1537 |
| 2-1/2" | 16.690 | 333.80 | Y1538 |
| 2-5/8" | 18.400 | 368.00 | - |
| 2-11/16" | 19.287 | 385.74 | Y1540 |
| 2-3/4" | 20.190 | 403.80 | Y1542 |
| 2-7/8" | 22.070 | 441.40 | Y1543 |
| 2-15/16" | 23.042 | 460.84 | Y1545 |
| 3" | 24.03 | 480.60 | Y1546 |
| 3-1/8" | 26.08 | 521.60 | Y1548 |
| 3-7/16" | 31.56 | 631.20 | Y1553 |
| 3-1/2" | 32.71 | 654.20 | Y1554 |
| 3-15/16" | 41.43 | 828.60 | Y1561 |
| 4" | 42.73 | 854.60 | Y1562 |
| 4-1/2" | 54.12 | 1082.40 | Y1567 |
| 5" | 66.81 | 1336.20 | Y1572 |
| 5-1/2" | 80.84 | 1616.80 | Y1575 |
| 6" | 96.21 | 1924.20 | Y1580 |

COLD FINISHED ROUND BAR - "1045" TG&P

| Size | Est. Weight - Lbs. | | Part No. |
|----------|--------------------|--------|----------|
| | Per Ft. | 20 Ft. | |
| 1-3/16" | 3.766 | 75.32 | Y1587 |
| 1-7/16" | 5.53 | 110.60 | Y8526 |
| 1-1/2" | 6.008 | 120.16 | Y1579 |
| 1-15/16" | 10.024 | 200.48 | Y1582 |
| 2" | 10.681 | 213.62 | Y1586 |
| 2-3/16" | 12.778 | 255.56 | Y1593 |
| 2-7/16" | 15.870 | 317.40 | Y1583 |

| Size | Est. Weight - Lbs. | | Part No. |
|----------|--------------------|--------|----------|
| | Per Ft. | 20 Ft. | |
| 2-15/16" | 23.042 | 460.84 | Y1581 |
| 3-1/2" | 32.71 | 654.20 | Y1589 |
| 3-7/16" | 31.56 | 631.20 | Y1584 |
| 3-15/16" | 41.43 | 828.60 | Y1588 |
| 4-7/16" | - | - | Y1591 |
| 4-15/16" | - | - | Y1590 |
| 5-7/16" | - | - | Y1592 |